



LED PUCK AIR CATENARY LIGHTING REIMAGINED

LED Puck Air is the incredibly lightweight, highly versatile, and exceptionally elegant catenary system for today's modern world. High performance yet only a fraction of the size and weight of other systems, Air enables safe, reliable, clutter-free catenary and welcomes infinite design possibilities for everything from outdoor gathering spaces to indoor accent lighting.



PLANET
LIGHTING



PUCK AIR
BRING IT TO THE NEXT LEVEL



CONTENT - PUCK AIR LUMINAIRES



PUCK AIR..... page 6

- How it works



PUCK AIR STANDARD page 10

- LED Puck AIR luminaire with 10 different light distributions



PUCK AIR AXIS..... page 10

- LED Puck AIR luminaire with tilting and swiveling mechanism and 10 different light distributions



PUCK AIR PENDANT page 10

- LED Puck AIR pendant luminaire with 10 different light distributions

BRIGHT

CONTENT - MOUNTING / LED DRIVER / ACCESSORIES

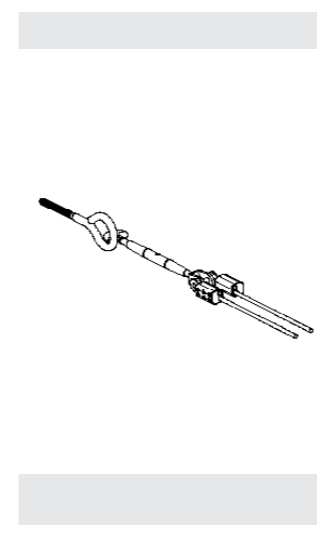

EYEBOLD MOUNT SET..... page 16

- Fastening set for cable mounting on concrete, wood or metal
- Ring bolt with M6 thread

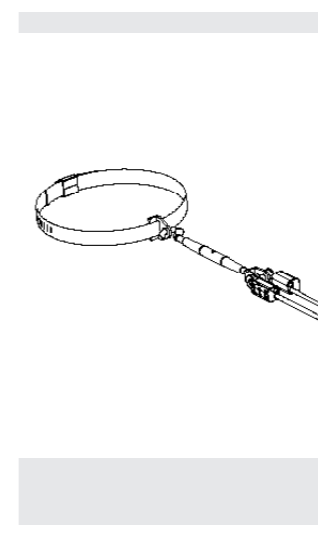

POLE and TREE MOUNT SET..... page 16

- Fastening set for catenary mounting on poles or trees
- Ø 50 - 441mm

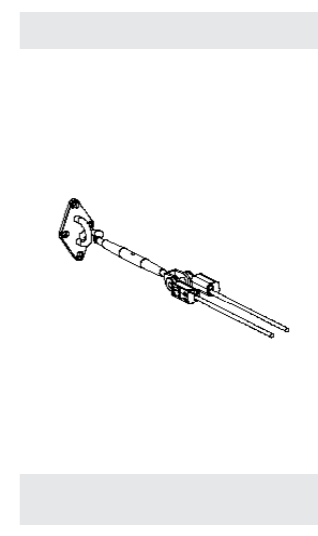

UNIVERSAL PLATE MOUNT SET..... page 16

- Fastening set for catenary mounting with universal mounting plate for many surfaces



SINGLE CORE CABLE = power cable.....page 16

- Tinned copper with Kevlar braid
- Power cable and suspension at the same time
- Ø 3mm

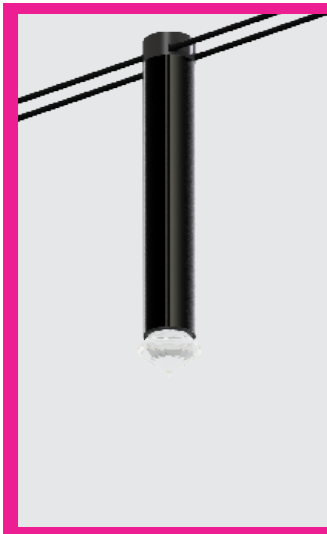

PUCK AIR DIAMOND page 14

- LED Puck AIR luminaire with diamond-shaped cover for special lighting effects

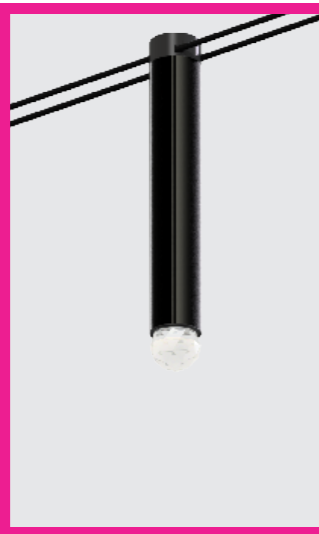

PUCK AIR PRISM..... page 14

- LED Puck AIR luminaire with prismatic cover for special lighting effects



PUCK AIR WAND..... page 14

- LED Puck AIR luminaire in the appearance of a magic wand.

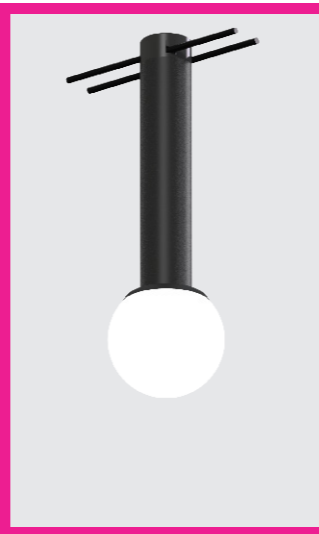

PUCK AIR GLOBE..... page 14

- LED Puck AIR luminaire in a classic spherical shape

DECORATIVE

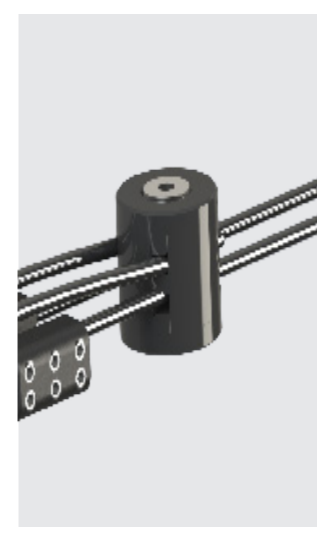

POWER HUB..... page 17

- Power supply or to stabilize the catenary system



LED POWER SUPPLY..... page 17

- 24V power supply in different wattages



LED DALI PWM CONVERTER..... page 17

- DALI converter for dimmable light control via DALI or push-dim function

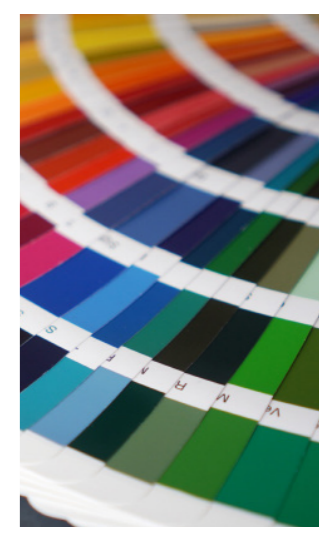

SPECIAL SOLUTIONS..... page 17

- Special colour options on request
- Customised attachment parts for decorative luminaires

- 1 Mounting set
- 2 Power hub
- 3 Kevlar cable
- 4 Puck Air

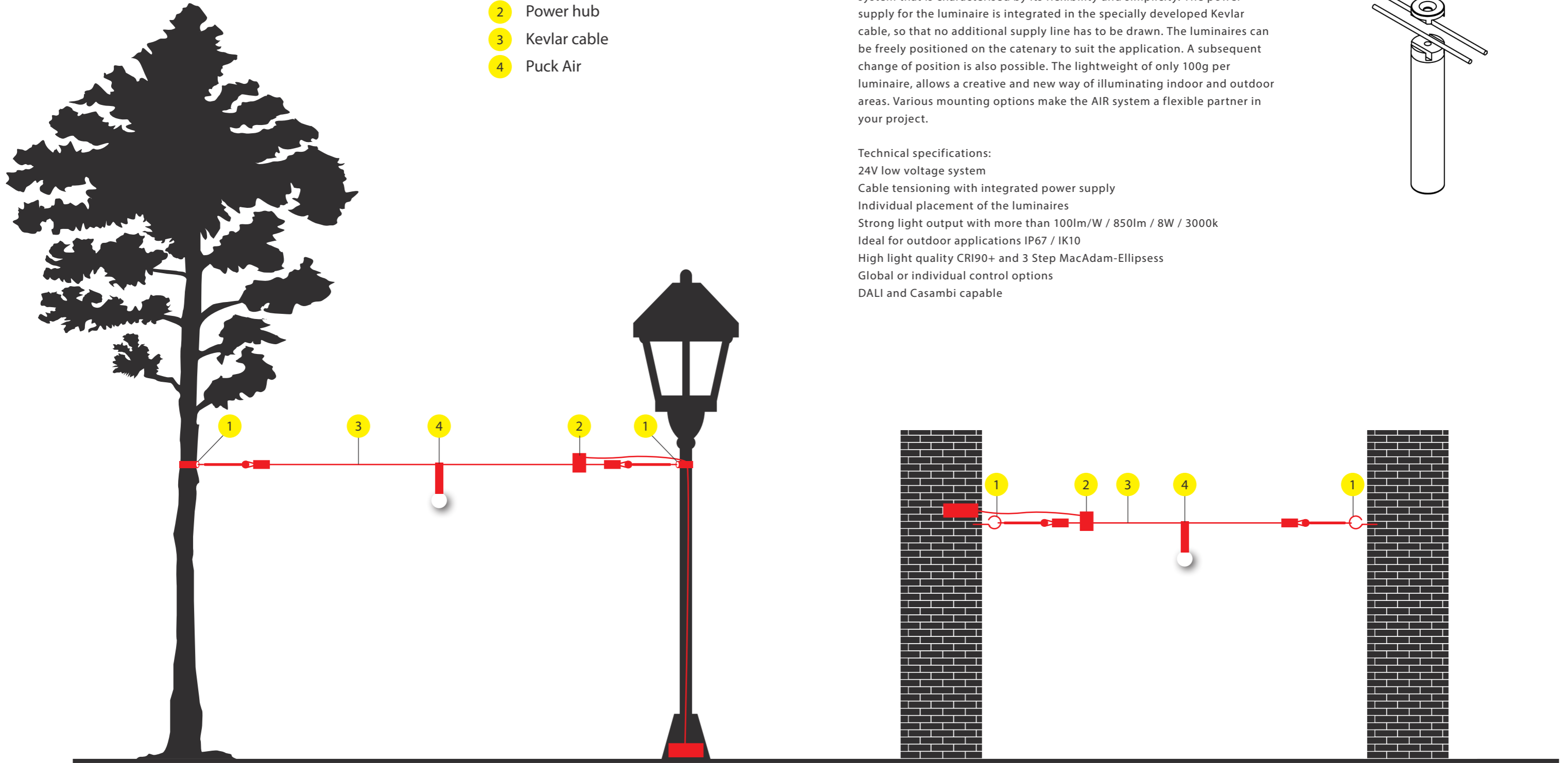

PUCK AIR - A lightweight takes off

Planet Lighting's LED Puck AIR series is an innovative 24V catenary lighting system that is characterised by its flexibility and simplicity. The power supply for the luminaire is integrated in the specially developed Kevlar cable, so that no additional supply line has to be drawn. The luminaires can be freely positioned on the catenary to suit the application. A subsequent change of position is also possible. The lightweight of only 100g per luminaire, allows a creative and new way of illuminating indoor and outdoor areas. Various mounting options make the AIR system a flexible partner in your project.

Technical specifications:

- 24V low voltage system
- Cable tensioning with integrated power supply
- Individual placement of the luminaires
- Strong light output with more than 100lm/W / 850lm / 8W / 3000k
- Ideal for outdoor applications IP67 / IK10
- High light quality CRI90+ and 3 Step MacAdam-Ellipsess
- Global or individual control options
- DALI and Casambi capable

Note on assembly:

- The luminaires must not be touchable
- Max. cable length per cable strand: 50m
- Max. number of luminaires per cable strand: 20 pieces
- Operation of several cable strands on one control gear possible
- Various mounting options see page 16

PUCK AIR
BRIGHT

STANDARD

PENDANT

ALUMINIUM
Marine grade

ANODISED
Black matte

ROTATABLE
Pan and tilt

AXIS

LED8 W
up to 850lm per Puck
>100lm/W
CRI 80+ (CRI 90+ on request)
3 Step MacAdam-Ellipsess
Protective cover made of
polycarbonate IP67 / IK10

INDOOR / OUTDOOR
MIN. - 40° / MAX. 55°
24V VOLTAGE
DALI / Casambi

BRING THE PUCK UP INTO THE AIR





PUCK AIR AXIS - Exhibition Archibald Award 2019, Coffs Harbour, Australia

TECHNICAL SPECIFICATIONS

• Mounting	Double wire suspension (Ø 3mm)
• Housing	Marine grade aluminium, anodised, black matte
• Dimensions	Diameter 25mm / Height 150mm / 100 gram
• Rated capacity	8W
• Light output	850lm (3000K)
• LED	CREE-XEG-XHP35.2HI
• Light colours	2700K / 3000K / 4000K
• Colour rendering index	CRI 80+ (CRI 90+ on request)
• Chromaticity stability	3 Step MacAdam-Ellipses
• Lifetime	50.000h L80 B10
• Protection class	IP67 (polycarbonate)
• Impact resistant class	IK10 (EN62262)
• Electrics	24V voltage

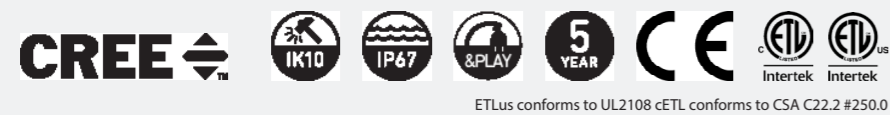

AIR AXIS - By pressing the side lock, the luminaire body can be tilted by 150°.

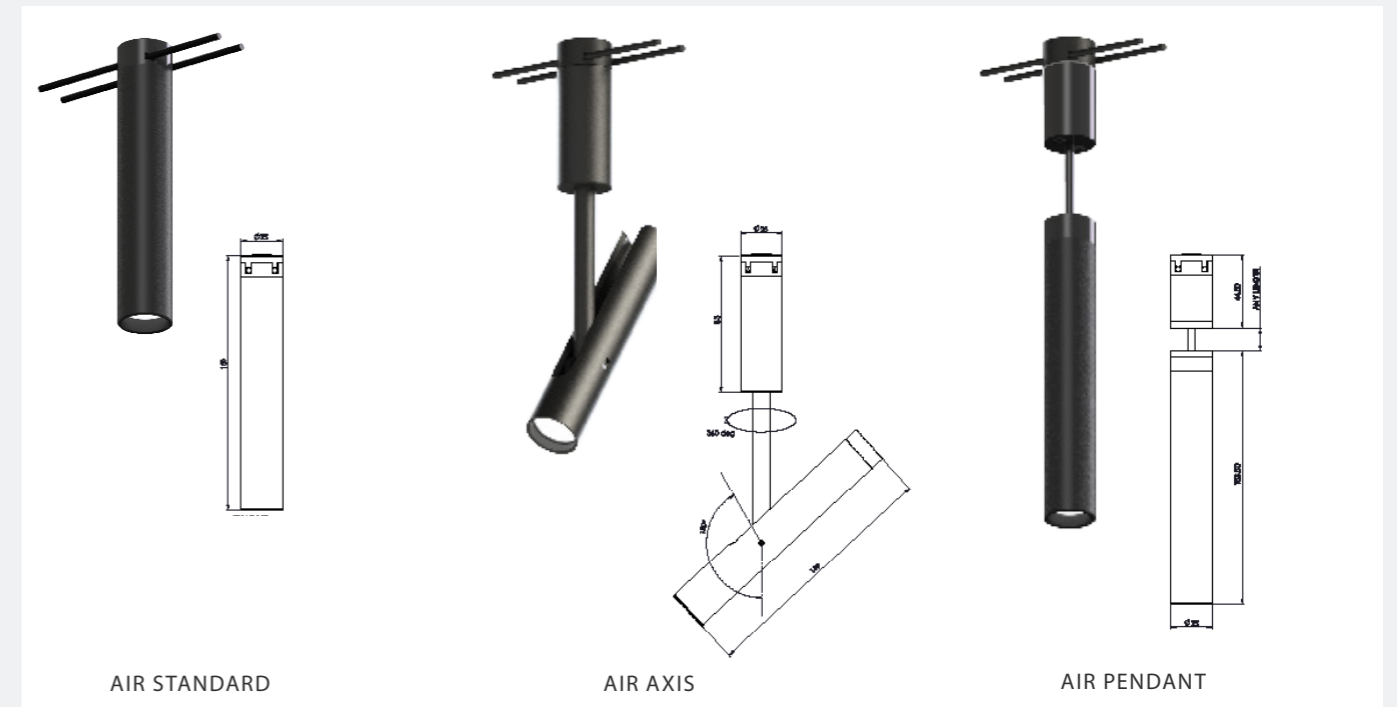

PUCK AIR FOR CATENARY SYSTEM

	Luminaire shapes	Light distributions	Light colours
AIR-CAT-	ST = Standard	● SP = Spot - symmetrical super narrow beam	27 = 2700K
	AX = Axis	● LN = Narrow - symmetrical narrow beam	30 = 3000K
	PD = Pendant	● LM = Medium - symmetrical medium beam	40 = 4000K
		● LW = Wide - symmetrical wide beam	
	● LO = Oval - wide elliptical beam		
	■ LS = Square - ultra-wide square beam		
	■ LL = Line - ultra-wide line batwing		
	● ZO = Zoom - flexible focus beam from narrow to wide		
	● IR = Iris - beam limiter from narrow to wide		
	● SN = Snoot - symmetrical beam with limiter producing a narrow spot with zero side spill		

Order example
AIR-CAT-ST-SP-27

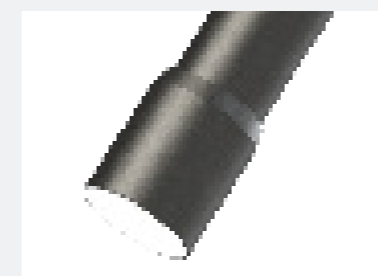

ZOOM - Stepless adjustment of the light cone for individualised light distribution.

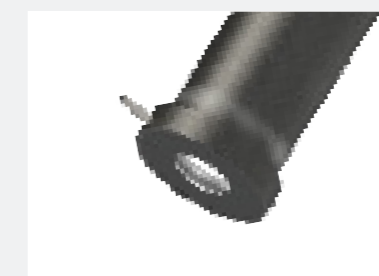

IRIS - Stepless adjustment of the light emission to individualise the light distribution.



SNOOT - Limiter with black reflector for reduced glare.



SHINE BRIGHT LIKE A PUCK AIR



PUCK AIR WAND - Al Maraya Island, Abu Dhabi

TECHNICAL SPECIFICATIONS

• Mounting	Double wire suspension (Ø 3mm)
• Housing	Marine grade aluminium, anodised, black matte
• Dimensions	Leuchtenkörper: Diameter 25mm / Height 150mm Diamond: Height 20mm Prism: Height 20mm Wand: Height 60mm Globe: Radius 27.5mm
• Rated capacity	8W
• Light output	850lm (3000K)
• LED	CREE-XEG-XHP35.2HI
• Light colours	2700K / 3000K / 4000K
• Colour rendering index	CRI 80+ (CRI 90+ on request)
• Chromaticity stability	3 Step MacAdam-Ellipses
• Lifetime	50.000h L80 B10
• Protection class	IP67 (polycarbonate)
• Impact resistant class	IK10 (EN62262)
• Electrics	24V voltage

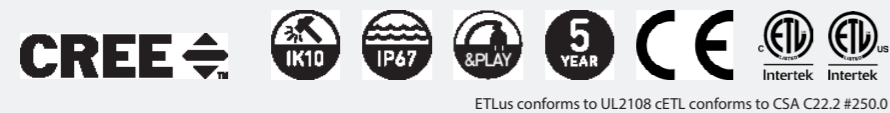

ETLus conforms to UL2108 cETL conforms to CSA C22.2 #250.0



PUCK AIR FOR CATENARY SYSTEM

	Luminaire shapes	Liteoptics	Light colours
AIR-CAT-	ST = Standard	DI = Diamond - cut glass, star-shaped light effect with a bright center	27 = 2700K
	AX = Axis	PR = Prism - cut glass, soft kaleidoscope effect	30 = 3000K
	PD = Pendant	WA = Wand - modern festoon effect	40 = 4000K
		GC = Globe closed - closed globe made of polycarbonate	
		GO = Globe open - globe open at the bottom made of polycarbonate	
		GG = Globe glass - closed globe made of glass	

Order example
AIR-CAT-ST-DI-27



GLOBE OPEN made of polycarbonate. Customised solutions possible on request, e.g. colored versions or special shapes

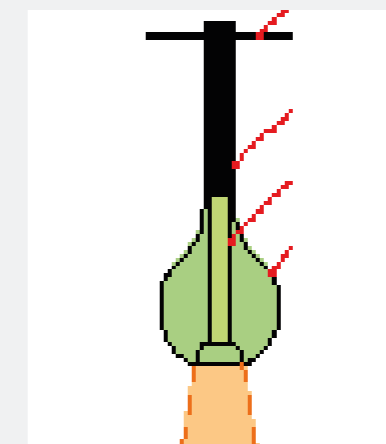



Exhibition Archibald Award 2019, Coffs Harbour, Australia

MOUNTING SET FOR CATENARY SYSTEMS

- POW/NON-TIM: Set for wood with 2 eyebolts, 2 turnbuckles and cable tensioner
- POW/NON-MAS: Set for masonry with 2 eyebolts, 2 turnbuckles and cable tensioner
- POW/NON-MET: Set for metal with 2 eyebolts, 2 turnbuckles and cable tensioner
- POW/NON-xxx: Set for poles and trees, 2 turnbuckles and cable tensioner (replace xxx with pole diameter in mm)
- POW/NON-PLA: Set for universal plate mount with 2 mounting plates, 2 turnbuckles and cable tensioner

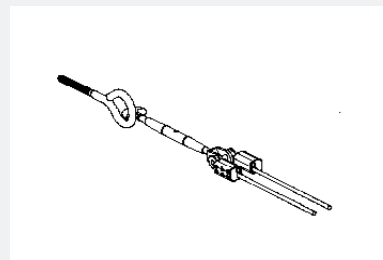

Eyebolt mounting set

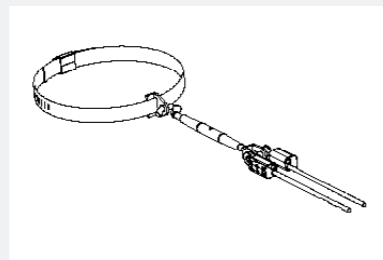

Poles and tree mounting set for diameters 50 - 441mm

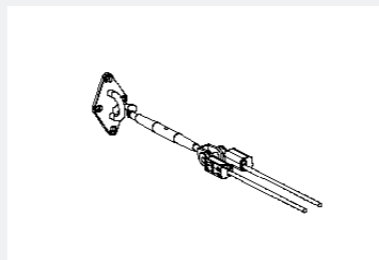

Universal mounting set

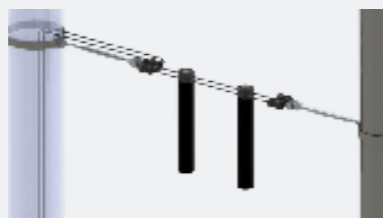

KEVLAR CABLE - CATENARY AND POWER SUPPLY

- AIR-Cable: Single core copper cable reinforced with Kevlar
- Nominal voltage: 150V
- Tensile stress: 100kg
- Max. length: 50m
- Colour: Black



POWER HUB

For power supply or optionally to be used as a reinforcement of the catenary system



LED POWER SUPPLY WITH METAL HOUSING, ENEC CERTIFIED

- Voltage: 24V
- Output current: 100W (length 220mm / width 68mm / height 38.8mm)
120W (length 220mm / width 68mm / height 39mm)
240W (length 244.2mm / width 68mm / height 38.8mm)
480W (length 262mm / width 125mm / height 43.8mm)
- Type of protection: IP65
- Protection class: II
- Lifetime: 62,000h
- Guarantee: 7 years

The maximum distance between the power supply and the catenary depends on the used size of the cable and the voltage of power supply.

Examples:

- 0.75 mm² cable and 24VDC max. 25m
- 1.5mm² cable and 24VDC max 50m
- 1.5mm² cable and 30VDC max 100m



LED DALI PWM CONVERTER

- DALI addresses: 4 programmable channels
- Dimming range: 1-100%
- Power consumption: <0.5W
- Type of protection: IP20
- Guarantee: 3 years
- Dimensions: 165x46x93mm



SPECIAL SOLUTIONS

Individual special solutions on request, e.g. special colour options or customised attachment parts for decorative luminaires.



PUCK AIR INSTALLATION

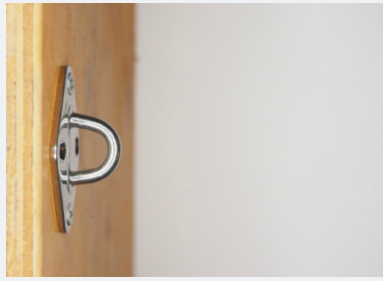

Attach the mounting plates to both ends.

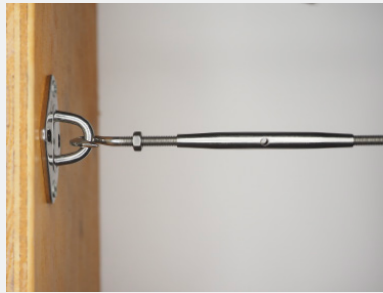

Hook in the turnbuckles to each mounting device and make sure that the cable turnbuckles are fully extended.



Pull the cable through the fixing block until it is tight and even in tension.



Slide the blocks up to the turnbuckle.

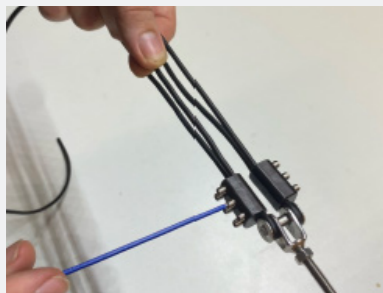

Hand tighten grub screws on each fixing block to secure the cabling.



Tension the cable by tightening the turnbuckles at both ends and securing with the locknuts. Hand tighten ONLY!



Align slots in luminaire head.



Attach the cap.



Screw on the cap to secure the connection.



Lead the cable to the power supply.

PUCK AIR APPLICATION EXAMPLES

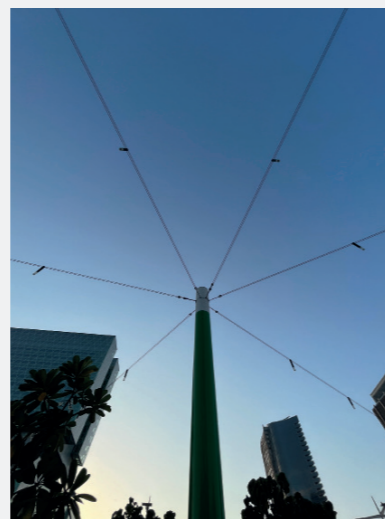
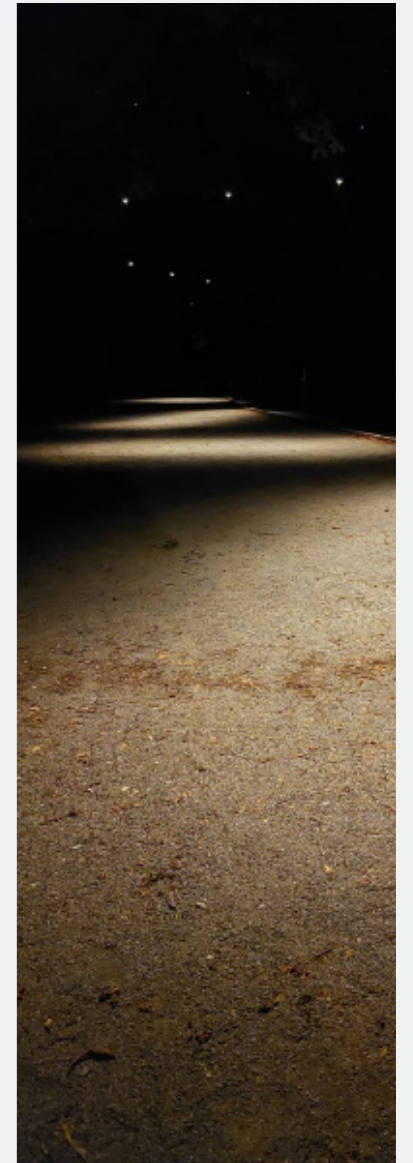
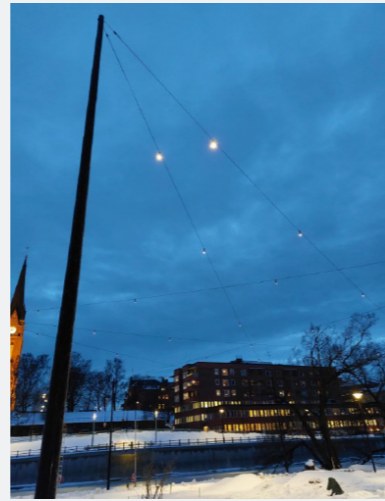

PUCK AIR OFFERS A WIDE RANGE OF POSSIBLE APPLICATIONS.
WE GIVE YOU INDIVIDUAL ADVICE.



KT Interior Oy. Energiakuja 3, katutaso (Technopolis 2) 00180 Helsinki
Phone +358 (0)10 235 1900 . E-Mail info@ktinterior.fi . www.ktinterior.fi

2024